

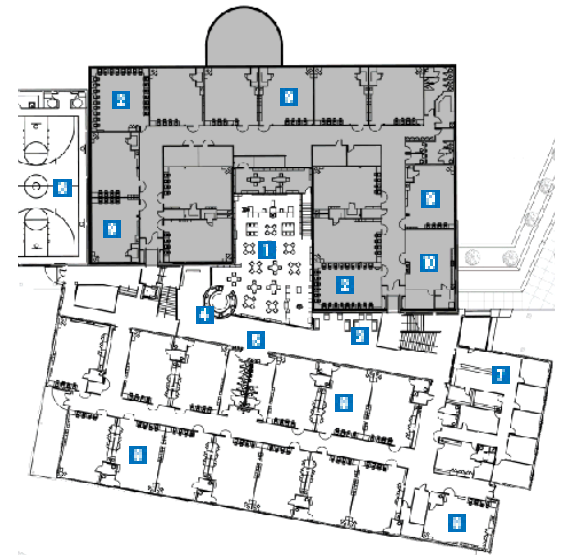

## Sky Harbour Elementary

**PROJECT** Sky Harbour Elementary School  
**CLIENT** Southwest Independent School District  
**ARCHITECT** Pfluger Associates Architects  
**DESIGN TEAM** Michelle Dudley, AIA; Kent Niemann, AIA  
**CONTRACTOR** Joeris General Contractors  
**CONSULTANTS** Persyn Engineering (structural); HMG & Associates (MEP); Civil Engineering Consultants (civil); C.F. Zavala Group (landscape)  
**PHOTOGRAPHERS** Clem Spalding; Michelle Dudley, AIA

**RESOURCES** CONCRETE PAVEMENT, ATHLETIC AND RECREATIONAL SURFACING, CONCRETE MATERIALS: Vulcan Materials; RECREATIONAL FACILITY AND PLAY-GROUND EQUIPMENT: Spalding; MASONRY UNITS: Acme; LIMESTONE: Chemical Lime New Braunfels; CAST STONE: Pyramid Stone; UNIT MASONRY WALL ASSEMBLIES: Hohmann & Barnard; METAL DECKING: Vulcraft; ARCHITECTURAL METAL WORK: Trans-Tex Fabricating; ROOF AND WALL PANELS, METAL ROOFING: Bethlehem Steel-Galvalume; MEMBRANE ROOFING: U.S. Ply; ENTRANCES AND STOREFRONTS: Kawneer; UNIT SKYLIGHTS: American Skylights; GLASS: AFGD Glass; GLAZED CURTAINWALL: Kawneer; ACOUSTICAL CEILINGS: BPB America (Baker/Triangle); ACOUSTICAL TREATMENTS: Tectum (Baker/Triangle); EIFS: Certain Teed (Baker/Triangle)



- GROUND FLOOR PLAN**
- 1 LIBRARY
  - 2 COMPUTER LAB
  - 3 READING ALCOVE
  - 4 LIGHTHOUSE
  - 5 ATRIUM
  - 6 PLAY GYM
  - 7 NEW ADMINISTRATIVE SUITE
  - 8 PRE-K THRU 1ST CLASSROOMS
  - 9 2ND THRU 5TH CLASSROOMS
  - 10 SPECIAL EDUCATION

■ PRE-EXISTING BUILDING

The 98,620-square-foot Sky Harbour Elementary School, located in the Southwest Independent School District of San Antonio, has been transformed from a solid concrete, windowless building into a series of welcoming, light-filled spaces. Pfluger Associates of San Antonio created a two-story classroom addition with a new administrative area. The firm also developed an atrium space to seamlessly connect the newly designed 47,016 square feet of space to the existing 52,604-square-foot building. Pfluger Associates incorporated the already established dolphin mascot and color scheme into the

new school's identity system. Architectural features reference marine symbology through the use of round, port-hole-like air diffusers, wave-inspired tile patterns, and a lighthouse reading nook. Sky Harbour Elementary School was recognized in the 2007 Exhibit of School Architecture for excellence in five out of five categories—design, educational appropriateness, innovation, process of planning, and value.

MEGAN BRALEY